

LAND AT MARSWORTH ROAD AND VICARAGE ROAD, PITSTONE

PUBLIC EXHIBITION & CONSULTATION ON PROPOSALS FOR DEVELOPMENT OF ALLOCATED SITE

(SITE ALLOCATED WITHIN PITSTONE DEVELOPMENT AREA COMPREHENSIVE PLAN)

PROPOSALS TO INCLUDE RESIDENTIAL DEVELOPMENT, POTENTIAL CHILDREN'S NURSERY AND PUBLIC HOUSE ON RESERVED SITES

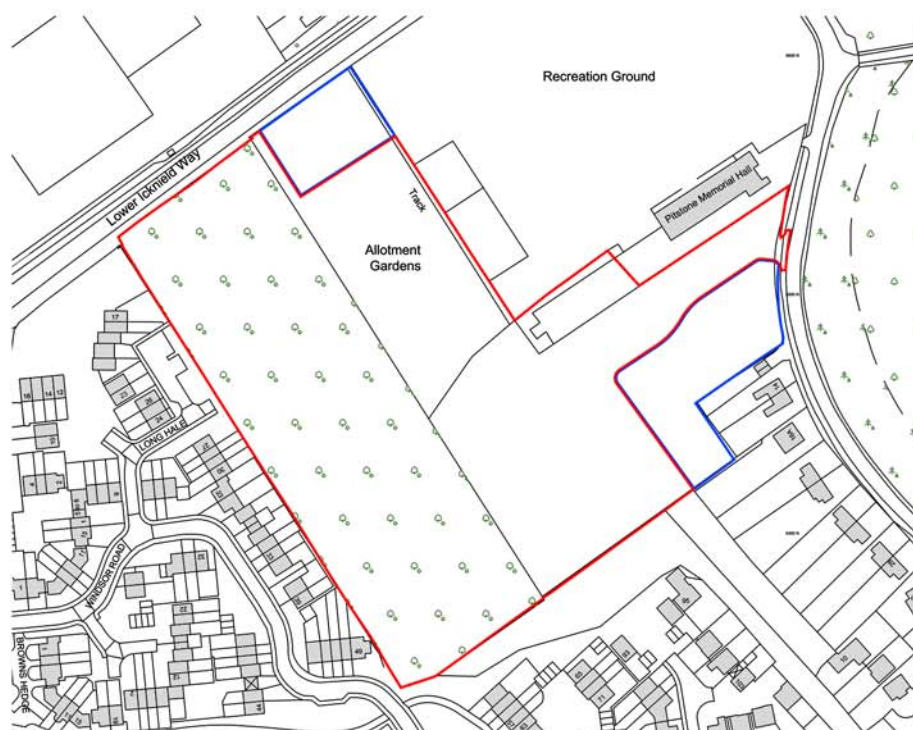

An exhibition to provide information and an opportunity for discussion and comment, on the proposals for the above site. All those interested, are invited to attend on:

Thursday 23rd February 2017

3.00pm - 7.15pm

in The Pitstone Memorial Hall

Representatives of the project team will be available at the event and there will be an opportunity to view the plans and make comments.